



**SPARTANBURG
COMMUNITY
COLLEGE**

**Invitation for Bids
Amendment #1**

Solicitation: SCC-355
 Date Issued: 06/30/2016
 Procurement Officer: Tami Steed
 Phone: 864-592-4671
 E-Mail Address: steedt@scsc.edu
 Mailing Address: Spartanburg Community College
 PO Box 4386
 Spartanburg SC 29305

DESCRIPTION: **Interior Door Hardware Replacement**

USING GOVERNMENTAL UNIT: **SPARTANBURG COMMUNITY COLLEGE**

SUBMIT YOUR SEALED OFFER AT THE FOLLOWING:

MAILING ADDRESS:
 SPARTANBURG COMMUNITY COLLEGE
 PURCHASING OFFICE
 PO BOX 4386
 SPARTANBURG SC 29305

PHYSICAL ADDRESS:
 SPARTANBURG COMMUNITY COLLEGE
 PURCHASING OFFICE Ledbetter Bldg Rm 238
 107 Community College Drive
 Spartanburg SC 29303

SUBMIT OFFER BY (Opening Date/Time): **07/12/2016 2:00 P.M.** (See "Deadline For Submission Of Offer" provision)

QUESTIONS MUST BE RECEIVED BY: **06/29/2016 3:00 P.M.** (See "Questions From Offerors" provision)

NUMBER OF COPIES TO BE SUBMITTED: **One (1) Original Document**

CONFERENCE TYPE: **Pre-Bid/Site Visit Conference**
 DATE & TIME: **06/28/2016 2:00 P.M.**

(As appropriate, see "Conferences - Pre-Bid/Proposal" & "Site Visit" provisions)

LOCATION:
**Spartanburg Community College
 Campus Operations
 136 Community College Drive
 Spartanburg, SC 29303**

AWARD &
 AMENDMENTS

Award will be posted on **07/14/2016**. The award, this solicitation, any amendments, and any related notices will be posted at the following web address: <http://www.scsc.edu/vendors>

You must submit a signed copy of this form with Your Offer. By signing, You agree to be bound by the terms of the Solicitation. You agree to hold Your Offer open for a minimum of thirty (30) calendar days after the Opening Date.
 (See "Signing Your Offer" provision.)

NAME OF OFFEROR

(full legal name of business submitting the offer)

Any award issued will be issued to, and the contract will be formed with, the entity identified as the Offeror. The entity named as the offeror must be a single and distinct legal entity. Do not use the name of a branch office or a division of a larger entity if the branch or division is not a separate legal entity, i.e., a separate corporation, partnership, sole proprietorship, etc.

AUTHORIZED SIGNATURE

(Person must be authorized to submit binding offer to contract on behalf of Offeror.)

DATE SIGNED

TITLE

(business title of person signing above)

STATE VENDOR NO.

(Register to Obtain S.C. Vendor No. at www.procurement.sc.gov)

PRINTED NAME

(printed name of person signing above)

STATE OF INCORPORATION

(If you are a corporation, identify the state of incorporation.)

OFFEROR'S TYPE OF ENTITY: (Check one)

(See "Signing Your Offer" provision.)

- Sole Proprietorship Partnership Other _____
 Corporate entity (not tax-exempt) Corporation (tax-exempt) Government entity (federal, state, or local)

PAGE TWO

(Return Page Two with Your Offer)

<p>HOME OFFICE ADDRESS (Address for offeror's home office / principal place of business)</p> 	<p>NOTICE ADDRESS (Address to which all procurement and contract related notices should be sent.) (See "Notice" clause)</p> <p align="right">_____ Area Code -</p> <p align="right">Number - Extension Facsimile</p> <p align="right">_____ E-</p> <p>mail Address</p>
---	---

<p>PAYMENT ADDRESS (Address to which payments will be sent.) (See "Payment" clause)</p> <p>____ Payment Address same as Home Office Address</p> <p>____ Payment Address same as Notice Address (check only one)</p>	<p>ORDER ADDRESS (Address to which purchase orders will be sent) (See "Purchase Orders and "Contract Documents" clauses)</p> <p>____ Order Address same as Home Office Address</p> <p>____ Order Address same as Notice Address (check only one)</p>
--	---

ACKNOWLEDGMENT OF AMENDMENTS
 Offerors acknowledges receipt of amendments by indicating amendment number and its date of issue. (See "Amendments to Solicitation" Provision)

Amendment No.	Amendment Issue Date	Amendment No.	Amendment Issue Date	Amendment No.	Amendment Issue Date	Amendment No.	Amendment Issue Date

<p>DISCOUNT FOR PROMPT PAYMENT (See "Discount for Prompt Payment" clause)</p>	10 Calendar Days (%)	20 Calendar Days (%)	30 Calendar Days (%)	____ Calendar Days (%)
---	----------------------	----------------------	----------------------	------------------------

PREFERENCES - A NOTICE TO VENDORS (SEP. 2009): On June 16, 2009, the South Carolina General Assembly rewrote the law governing preferences available to in-state vendors, vendors using in-state subcontractors, and vendors selling in-state or US end products. This law appears in Section 11-35-1524 of the South Carolina Code of Laws. A summary of the new preferences is available at www.procurement.sc.gov/preferences. ***ALL THE PREFERENCES MUST BE CLAIMED AND ARE APPLIED BY LINE ITEM, REGARDLESS OF WHETHER AWARD IS MADE BY ITEM OR LOT. VENDORS ARE CAUTIONED TO CAREFULLY REVIEW THE STATUTE BEFORE CLAIMING ANY PREFERENCES. THE REQUIREMENTS TO QUALIFY HAVE CHANGED. IF YOU REQUEST A PREFERENCE, YOU ARE CERTIFYING THAT YOUR OFFER QUALIFIES FOR THE PREFERENCE YOU'VE CLAIMED. IMPROPERLY REQUESTING A PREFERENCE CAN HAVE SERIOUS CONSEQUENCES.*** [11-35-1524(E)(4)&(6)]

PREFERENCES - ADDRESS AND PHONE OF IN-STATE OFFICE: Please provide the address and phone number for your in-state office in the space provided below. An in-state office is necessary to claim either the Resident Vendor Preference (11-35-1524(C)(1)(i)&(ii)) or the Resident Contractor Preference (11-35-1524(C)(1)(iii)). Accordingly, you must provide this information to qualify for the preference. An in-state office is not required, but can be beneficial, if you are claiming the Resident Subcontractor Preference (11-35-1524(D)).

____ In-State Office Address same as Home Office Address

____ In-State Office Address same as Notice Address (check only one)

Amendment #1
Invitation for Bid # SCC-355

AMENDMENTS TO SOLICITATION (JANUARY 2006) (a) The Solicitation may be amended at any time prior to opening. All actual and prospective Offerors should monitor the following web site for the issuance of Amendments: <http://www.sccsc.edu/Vendors> . (b) Offerors shall acknowledge receipt of any amendment to this solicitation (1) by signing and returning the amendment, (2) by identifying the amendment number and date in the space provided for this purpose on Page Two, (3) by letter, or (4) by submitting a bid that indicates in some way that the bidder received the amendment. (c) If this solicitation is amended, then all terms and conditions which are not modified remain unchanged.

ACKNOWLEDGE RECEIPT OF THIS AMENDMENT.

Listed below are the responses to the questions received by the designated date:

Q. 1. Will additional time be added per the addendum for the completion of this project beyond the original 60 days as discussed in the meeting?

A. 1. The time for completion is changed from 60 days to 90 days.

Q. 2. Can you confirm the escutcheon plates are Corbin Russwin products?

A. 2. Escutcheon plates are Rockwood # 70-Mod US32D 3" x 9" with cut outs

Q. 3. Can you tell me what finish to price/furnish regarding the locks?

A. 3. All hardware is to have standard 626 finish.

A floor plan and existing lockset list for the Powers and Hull Buildings are provided as information.

Hull Building Room Numbers

Room #	Room Classification	Lockset
E1	advising	rim exit device
E1C	office	cylindrical
E2	tutoring	rim exit device
E2	tutoring	rim exit device
E2D	office	mortise
E2F	storeroom	mortise
E3	testing	mortise
E3A	office	mortise
E3A	office	mortise
E4	office	mortise
E4	office	cylindrical
E4F (2)	office	cylindrical
E5	lab	rim exit device
E5	lab	mortise

E6	classroom	mortise
E9	office	mortise
E9I	office	mortise
E10A	office	mortise
E10E	office	mortise
E12	office	mortise
E12	office	mortise
E12A	office	mortise
E13	lab	mortise
E14	workroom	mortise
E15A	lab	mortise
E16	classroom	mortise
E18	lab	mortise
E18	lab	mortise
E20	lab	mortise
E20A (2)	storeroom	mortise
E20S	storeroom	mortise
E20S	storeroom	cylindrical
E21	lab	mortise
E22	lab	mortise
E24	lab	mortise
E24	lab	mortise
E25	classroom	mortise
E25	classroom	mortise
E30A	office	cylindrical
E30B	office	cylindrical
E30C	office	cylindrical
E30D	office	cylindrical
E30E	office	cylindrical
E31	breakroom	storefront mortise
E33	lab	concealed vertical rod
E33A	lab	storefront mortise
E33C	classroom	cylindrical
E33C	classroom	rod in frame
E33D	classroom	cylindrical
E33D	classroom	mortise
E35	lab	storefront mortise
E36	workroom	mortise
E36	workroom	cylindrical
E38	office	mortise
E39	mechanical	mortise
E40	office	mortise
E41	storeroom	mortise

E43	lab	cylindrical
E43A	lab	mortise
E43A	lab	mortise
E44	office	mortise
E46	lab	mortise
E46D	lab	rim exit device
E46F	lab	mortise
E46H	classroom	cylindrical
E47A	classroom	mortise
E47C	office	mortise
E47D	office	mortise
E48J	lab	mortise
E48K	lab	mortise
E49	lab	cylindrical
E49D	classroom	mortise
E52	office	mortise
E53	office	mortise
E54	office	mortise
E55	office	mortise
E56	office	cylindrical
E56D	workroom	mortise
E57	lab	mortise
E59	lab	cylindrical
E60	lab	cylindrical
E60B	classroom	cylindrical
E60C	lab	cylindrical
E60D	office	cylindrical
E60G	classroom	cylindrical
E61A	classroom	mortise
E61A	classroom	cylindrical
E61B	lab	cylindrical
E61A	lab	cylindrical
E62A	lab	cylindrical
E62B	lab	cylindrical



**SPARTANBURG
COMMUNITY
COLLEGE**

Business 1-85 at New Cut Road
P.O. Box 4386
Spartanburg, S.C. 29305
(864) 592-4600 or 1-800-922-3679

P. Dan Hull Building Floor Plan

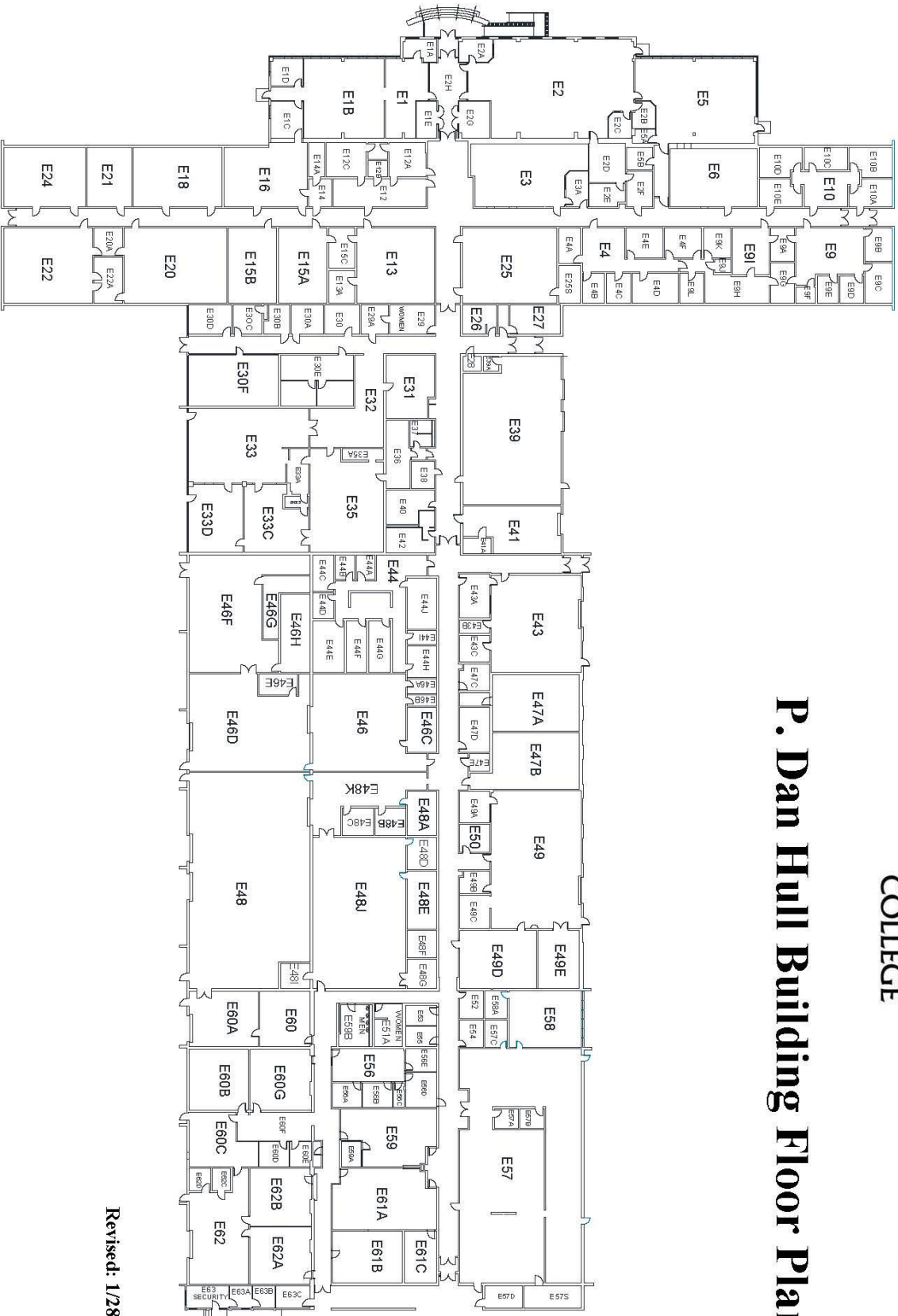

Revised: 1/28/2015

Powers Building Room Numbers

Room #	Room Classification	Lockset
A1	classroom	mortise
A2	classroom	mortise
A3	office	mortise
A4	classroom	mortise
A5	classroom	mortise
A6	classroom	mortise
A7	classroom	mortise
A7S	storeroom	mortise
A7S	storeroom	mortise
A8	classroom	mortise
A9	classroom	mortise
A10	classroom	mortise
A10S	storeroom	mortise
A10S	storeroom	cylindrical
A10S	storeroom	mortise
A11	storeroom	mortise
A12	classroom	mortise
A13	lab	mortise
A13	lab	mortise
A14	lab	mortise
A14S	storeroom	cylindrical
A15	lab	mortise
A17	classroom	mortise
A19A	classroom	cylindrical
A19B	classroom	cylindrical
A19B	classroom	mortise
A20A	office	mortise
A20B	office	mortise
A21	office	mortise
A22	office	mortise
A23	office	mortise
A24	office	mortise
A25	office	mortise
A26	office	mortise
A27	mechanical	mortise
A28	office	mortise
A29	office	mortise
A30	office	mortise
A31	office	mortise
A32	office	mortise

A33	workroom	mortise
A33	workroom	mortise
A34	office	mortise
A35	office	mortise
A36	office	mortise
A37	office	mortise
A38	storeroom	mortise
A38	storeroom	mortise
A39	office	mortise

B1	lab	mortise
B1	lab	mortise
B2	classroom	mortise
B3	classroom	mortise
B4	classroom	mortise
B5	lab	mortise
B5	lab	mortise
B6	classroom	mortise
B7	classroom	mortise
B8	classroom	mortise
B9	office	mortise
B10	lab	mortise
B11	classroom	mortise
B12	classroom	mortise
B16	office	mortise
B17	adjunct office	mortise
B17	adjunct office	mortise
B19	office	mortise
B20	office	mortise
B21	office	cylindrical
B22	office	cylindrical
B23	office	cylindrical
B24	office	cylindrical
B25	office	cylindrical
B26	office	cylindrical
B27	mechanical	cylindrical
B28	office	cylindrical
B29	office	cylindrical
B30	office	cylindrical
B31	office	cylindrical
B32	office	cylindrical

C3	office	mortise
C4A	office	cylindrical
C4B	office	mortise
C4B	office	mortise
C4C	office	cylindrical
C4D	office	mortise
C4D	office	mortise
C4E	office	mortise
C4E	office	mortise
C4F	lab	storefront mortise
C4G	office	storefront mortise
C4H	lab	storefront mortise
C4I	lab	cylindrical
C4J	lab	cylindrical
C4K	lab	cylindrical
C4L	lab	cylindrical
C4M	lab	cylindrical
C5	office	mortise
C6	breakroom	mortise
C13	office	mortise
C14	office	mortise
C15	office	mortise
C16	storeroom	mortise
C17	office	mortise
C18	office	mortise
C19	office	mortise
C20	office	mortise
C21	office	mortise
C21B	office	cylindrical
C22	office	mortise
C23	office	mortise
C24	office	mortise
C25	office	mortise
C26A	storeroom	mortise
C27	office	mortise

D1	classroom	mortise
D2	lab	mortise
D2S	storeroom	mortise
D2S	storeroom	mortise

D3	classroom	mortise
D4	lab	mortise
D5	office	mortise
D6	classroom	mortise
D6A	classroom	mortise
D7	classroom	mortise
D7	classroom	mortise
D7C	office	mortise
D7O	lab	mortise
D7O	lab	mortise
D8	classroom	mortise
D9	classroom	mortise
D9S	office	mortise
D9S	office	mortise
D10	classroom	mortise
D11	office	mortise
D12	classroom	mortise
D13	classroom	mortise
D14	classroom	mortise
D15	classroom	mortise
D16	classroom	mortise
D17	classroom	mortise
D19	office	mortise
D25	mechanical	mortise



**SPARTANBURG
COMMUNITY
COLLEGE**

Business I-85 at New Cut Road
P.O. Box 4386
Spartanburg, S.C. 29305
(864) 592-4600 or 1-800-922-3679

Jack A. Powers Building Floor Plan

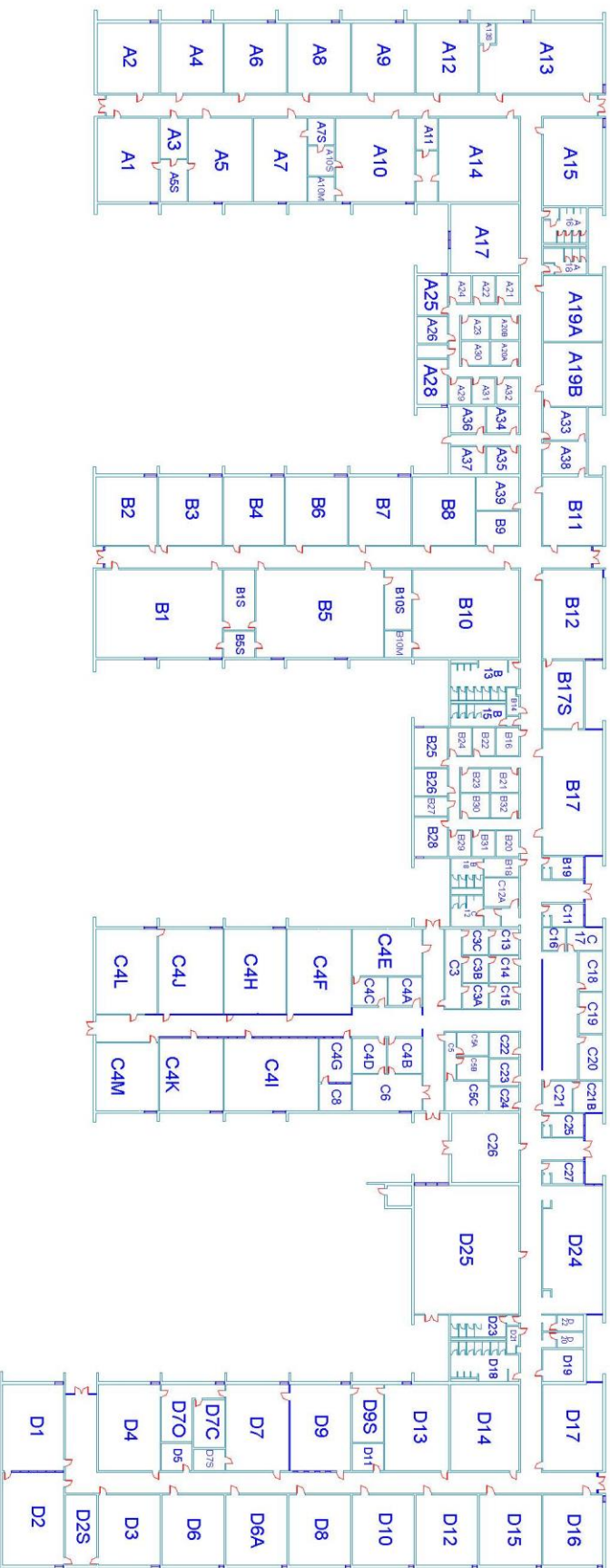

Revised: 10/05/2015